

the CEDAR

3 bedroom terrace home

WestKent

Places to live. Space to grow.

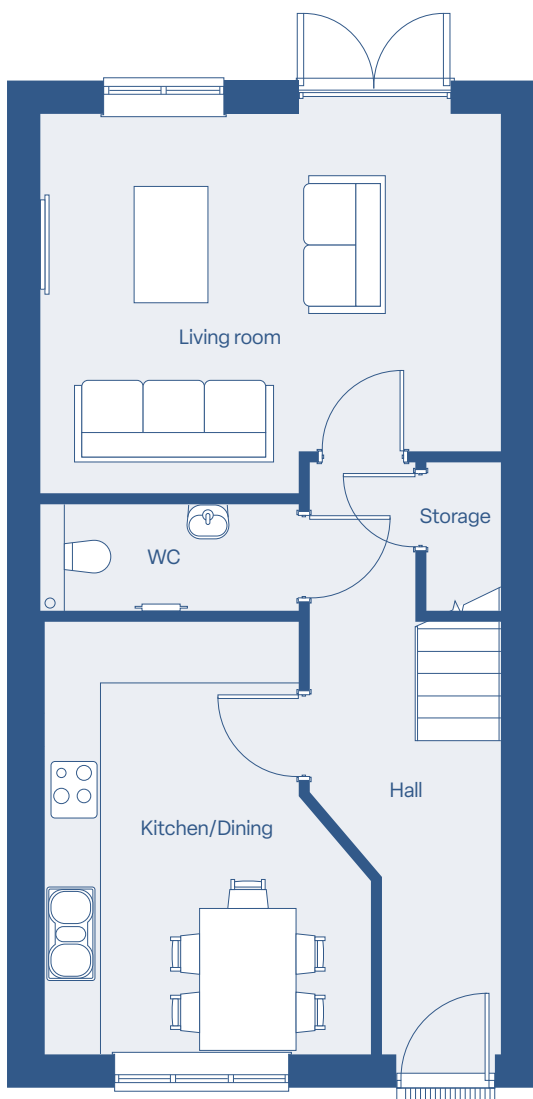

Ground Floor Plan

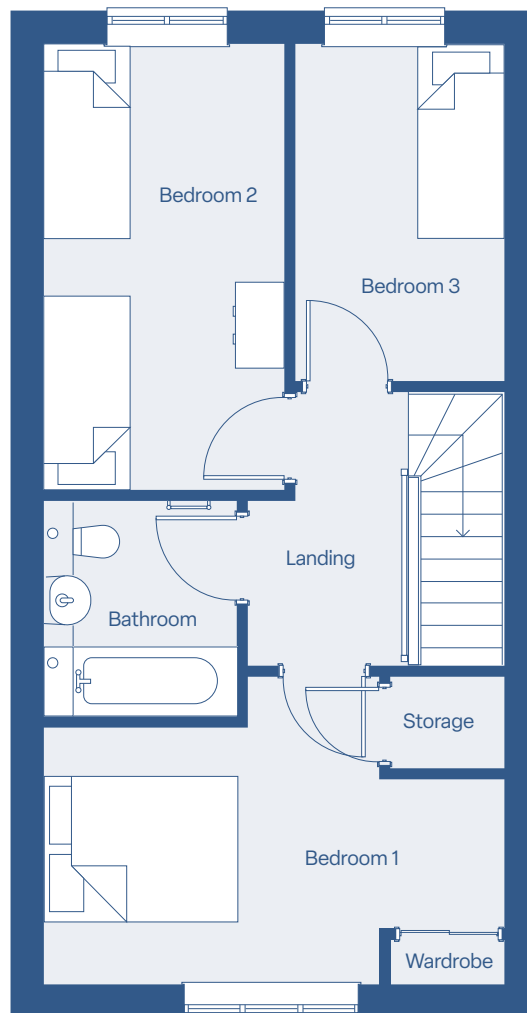

First Floor Plan

Dimensions

Living/Dining	3.9 m × 4.8 m
Kitchen	3.4 m × 4.5 m
WC	1.1 m × 2.7 m
Bedroom 1	3.2 m × 4.8 m
Bedroom 2	2.5 m × 4.6 m
Bedroom 3	2.2 m × 3.5 m
Bathroom	2.0 m × 2.2 m
Total size	93 m²